



Zero Gravity - Fascia or Open Roll Instructions

These steps are not required for Zero Gravity in Curved Cassettes.
Skip these steps if using chain, Neo, or motorized control

If the Pin End of the shade appears as shown here, proceed with **Steps 1,2 & 3** before returning to **Step 4** of the **Open Roll Installation Instructions**



If the Pin End of the shade appears as shown here, proceed with **Steps 4,5 & 6** before returning to **Step 4** of the **Open Roll Installation Instructions**



1 PREPARING FOR INSTALLATION

NOTE: The blue shipping lock is used to lock the tension in place during shipping.

Hex Plunger
Remove shipping lock before installing



2 INSTALLING THE SYSTEM

(A) Insert the pin end of the blind into the bracket.

(B) Insert the hooked end into the other side bracket, and ensure the Zero Gravity head sits on the hooked teeth firmly. This should compress the hex plunger which releases the tension onto the shade.

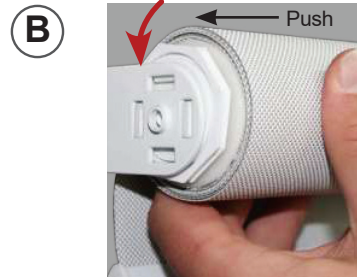
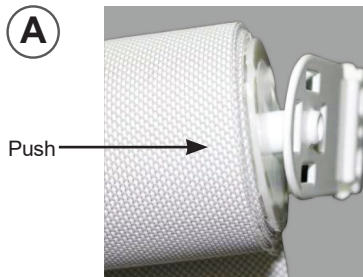

3 TESTING THE SYSTEM

Always operate the shade from the center of the bottom bar. Ensure that the shade is balanced and does not want to roll up or down on its own. If it does, then the spring will require more or less tension to be perfectly balanced. If the shade requires more tension, turn the zero gravity head into the fabric, **ie opposite direction to the fall of the fabric.**

Insert for 5mm hex
(only for outside mount)



Adjusting Spanner

Zero Gravity Mini - Pin Lock Instructions

These steps are not required for Zero Gravity in Curved Cassettes.
Skip these steps if using chain, Neo, or motorized control



WARNING

- Do not pull pin lock out until shade is installed or tension will be released.
- If tension has been released, see trouble shooting.

1 RUBBER BAND REMOVAL

Before installing the shade remove the rubber band holding the Pin Lock in place.

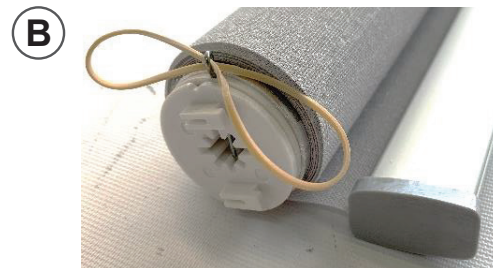

2 INSTALL SHADE AND REMOVE PIN LOCK

C: Install roller shade while keeping Pin Lock toward you and held in place.

D: After installation remove the pin lock

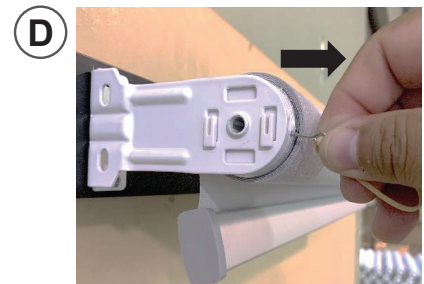
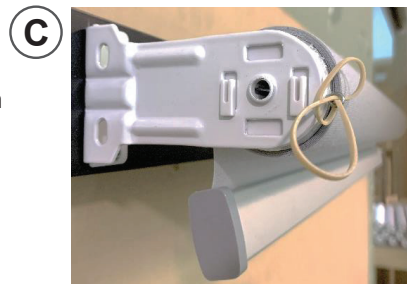

3 TESTING THE INSTALLED ROLLER SHADE

Installed roller shade must be operated smoothly by the centre of the bottom bar to avoid excessive telescoping



TROUBLE SHOOTING: ONLY REQUIRED IF TENSION IS RELEASED

If the tension is released or removed accidentally follow these instructions:
The tension can be put back in any Zero Gravity Mini by turning the clutch head in the opposite direction of the fabric approximately 1 – 2 full rotations. While holding tension, insert the Pin Lock into the hole of the clutch. **PROCEED WITH STEP 2 WHEN FINISHED.**

